

# Licensing Panel AGENDA

**DATE:** Tuesday 6 March 2012

**TIME:** 7.00 pm \*

**VENUE:** Committee Room 6,  
Harrow Civic Centre

\* THERE WILL BE A BRIEFING FOR MEMBERS AT 6.00PM IN COMMITTEE ROOM 6.

## **MEMBERSHIP** (Quorum 3)

---

**Chairman:** (To be appointed)

**Councillors:**

Ajay Maru  
Ben Wealthy

Manji Kara

## **Reserve Members:**

---

**Note:** There are no Reserve Members currently appointed to this Panel.

**Contact:** Mark Doherty, Democratic Services Officer  
Tel: 020 8416 8050 E-mail: mark.doherty@harrow.gov.uk

## **AGENDA - PART I**

### **1. APPOINTMENT OF CHAIRMAN**

To appoint a Chairman for the purposes of this meeting.

### **2. DECLARATIONS OF INTEREST**

To receive declarations of personal or prejudicial interests, arising from business to be transacted at this meeting, from:

- (a) all Members of the Sub Committee;
- (b) all other Members present in any part of the room.

### **3. MINUTES**

[Note: Licensing Panel minutes are:-

- (1) approved following each meeting by the Members serving on that particular occasion and signed as a correct record by the Chairman for that meeting;
- (2) not submitted to the next panel meeting for approval.

Reasons: The Licensing Panel is constituted from a pooled membership. Consequently, a subsequent Panel meeting is likely to comprise a different Chairman and Members who took no part in the previous meeting's proceedings. The process referred to at (1) above provides appropriate approval scrutiny].

### **4. PUBLIC QUESTIONS, PETITIONS AND DEPUTATIONS**

To receive any questions, petitions or deputations (if any), under the provisions of Committee Procedure Rules 17, 15 and 16 (Part 4B) of the Constitution respectively.

*[Note: These items are qualified by the requirements of the licensing legislation and will not be applicable to applications on the current agenda.]*

### **5. LICENSING PROCEDURES (Pages 1 - 2)**

Procedure to be followed at an oral hearing.

### **6. ANY OTHER URGENT BUSINESS**

Which cannot otherwise be dealt with.

### **7. APPLICATION FOR A NEW PREMISES LICENCE IN RESPECT OF 'HILL FOODS', 43 HIGH STREET, HARROW ON THE HILL, HA1 3HT (Pages 3 - 26)**

Report of the Corporate Director Community and Environment.

**8. APPLICATION TO VARY A PREMISES LICENCE IN RESPECT OF 'KEMPS FISH BAR', 327, HIGH ROAD, HARROW WEALD. HA3 5EQ (Pages 27 - 66)**

Report of the Corporate Director Community and Environment.

**AGENDA - PART II - NIL**

This page is intentionally left blank

*This document provides a summary of the Panel's usual procedure for the conduct of an oral hearing in public.*

1. Introduction by chair of:
  - Members
  - Officers and Officers of Responsible Authorities
  - Applicants and Objectors
  - the procedure for the hearing.
  
2. Presentation of the report by Officers of the Relevant Authority.
  
3. Presentation by the applicant of their statement. Additional material may be submitted with the agreement of the Panel and the other party, subject to advice by the Council's legal advisor at the time.
  
4. Questioning of applicant by:
  - each of the objectors
  - the Panel
  
5. Presentation by the objectors, or their representative of their statements. Additional material may be submitted with the agreement of the Panel and the other party, subject to advice by the Council's legal advisor at the time.
  
6. Questioning of each objector by:
  - the applicant
  - the Panel
  
7. Concluding statement(s) by objectors.
  
8. Concluding statement by applicant.
  
9. The Panel together with their legal advisor and committee clerk withdraw to consider of the application. Should the Panel wish to clarify any point with any particular party, all sides are recalled for the questions to be asked.
  
10. The hearing is reconvened for the Panel to announce their decision. Should the application be refused or conditions be placed on the licence the Panel must give reasons for this action.

## **NOTES**

***WITNESSES:*** *Either side may call witnesses to support their case. Witnesses should have submitted written statements before the hearing which they present and on which they may be questioned. Witnesses introduced at short notice may speak with the agreement of the Panel and the other party, subject to advice by the Council's legal advisor at the time.*

***ADJOURNMENT:*** *The Panel may at any time adjourn to a later date for the further consideration of an application. The date and time should be agreed with all parties as far as possible*

This page is intentionally left blank

## REPORT FOR: LICENSING PANEL

|                             |                                                                                                                |
|-----------------------------|----------------------------------------------------------------------------------------------------------------|
| <b>Date:</b>                | 14 February 2012                                                                                               |
| <b>Subject:</b>             | Application for a new premises licence in respect of 'Hill Foods', 43 High Street, Harrow on the Hill, HA1 3HT |
| <b>Responsible Officer:</b> | Brendon Hills – Corporate Director, Community & Environment                                                    |
| <b>Exempt:</b>              | No                                                                                                             |
| <b>Enclosures:</b>          | Application for premises licence<br>Plan of the premises<br>Location (GIS) Map<br>Representations              |

### Section 1 – Summary

The application for a new premises licence issued under the Licensing Act 2003 in respect of 'Hill Foods', 43 High Street, Harrow on the Hill, HA1 3HT has attracted three representations from interested parties; two representations oppose the application and one representation supports the application. As per the Council's Licensing Policy and delegation of Licensing functions, all applications with unresolved representations are to be dealt with by the Licensing Panel.

### Representations received

| From                                                                     | Relevant Representations details |
|--------------------------------------------------------------------------|----------------------------------|
| The Planning Authority                                                   | No representations received      |
| Health & Safety                                                          | No representations received      |
| Environmental Health Authority (Pollution and environmental enforcement) | No representations received      |
| Trading Standards                                                        | No representations received      |
| The Area Child Protection Service                                        | No representations received      |
| LFEPA                                                                    | No representations received      |
| Metropolitan Police                                                      | No representations received      |

### Representations from interested parties

| From               | Relevant Representations details |
|--------------------|----------------------------------|
| Interested Parties | Representations Received         |

## **Section 2 – Report**

### **Current situation**

- 2.1 The applicant, Mr Mylvayanam Asokan, has applied for a new premises licence in respect of 'Hill Foods', 43 High Street, Harrow on the Hill, HA1 3HT. The application seeks to permit the sale of alcohol for consumption off the premises only during the following timings:

Sale of Alcohol:

|                      |                   |
|----------------------|-------------------|
| Mondays to Saturdays | 07.00am – 11.00pm |
| Sundays              | 09.00am – 10.00pm |

Hours Open to Public:

|                      |                   |
|----------------------|-------------------|
| Mondays to Saturdays | 07.00am – 11.00pm |
| Sundays              | 09.00am – 10.00pm |

- 2.2 The premises is situated at 43 High Street, Harrow on the Hill, HA1 3HT in a parade of commercial premises with residential properties and Harrow School in the immediate vicinity. A map of the area is attached to this report.
- 2.3 The application proposes that Mr Mylvayanam Asokan will be the designated premises supervisor, authorising sale of alcohol at the premises. It should be noted that Mr Mylvayanam Asokan does not currently hold a personal licence and, at this moment in time, no application has been made to Harrow Council as the relevant authority for a personal licence for Mr Mylvayanam Asokan.

### **Representations**

- 2.4 The application for a new premises licence has attracted three representations from interested parties; two representations oppose the application and one representation supports the application. Copies of the representations received are attached to this report.

### **Consultation**

- 2.5 The application was advertised in accordance with the Regulations under the Licensing Act 2003.

### **Licensing Policy Implications**

- 2.6 In relation to the Council's Licensing policy at paragraphs 8.3 and 8.8, the applicant has addressed how he intends to promote the licensing objectives.

### **Legal Implications**

- 2.7 The Licensing Panel is required to hold a hearing to consider the application and any relevant representations unless all parties agree that a hearing is unnecessary. The



hearing must be held in accordance with the Licensing Act 2003 (Hearings) Regulations 2005.

2.8 The Licensing Panel is required to give appropriate weight to the representations (including supporting information) presented by all the parties, the Guidance issued pursuant to section 182 of the Licensing Act 2003, the Council's statement of licensing policy and the steps that are necessary to promote the four licensing objectives.

2.9 Having considered those relevant matters, the Licensing Panel is required to take such of the following steps (if any) as it considers necessary for the promotion of the four licensing objectives –

The steps are—

(a) to grant the licence subject to—

(i) conditions that are consistent with the operating schedule accompanying the application modified to such extent as the authority considers necessary for the promotion of the licensing objectives, and

(ii) any condition which must under section 19, 20 or 21 Licensing Act 2003 be included in the licence;

(b) to exclude from the scope of the licence any of the licensable activities to which the application relates;

(c) to refuse to specify a person in the licence as the premises supervisor;

(d) to reject the application

For the purposes of 2.9(a)(i) above, the conditions of the licence are modified if any of them is altered or omitted or any new conditions added.

2.10 It should be noted with all options that –

- Clear reasons should be given for the decision.
- Any additional or modified conditions should be practical and enforceable
- The applicant and any person who made relevant representations would have the right of appeal to a magistrates' court on one of the grounds provided in Schedule 5 to the Licensing Act 2003

2.11 In addition to determining the application in accordance with the legislation, Members must have regard to –

- The common law rules of natural justice
- The provisions of the Human Rights Act 1998
- The considerations in section 17 of the Crime and Disorder Act 1998

2.12 By section 6 of the Human Rights Act 1998, the Panel is required to act in a way that is compatible with rights under the European Convention for the Protection of Human Rights. The following provisions of the European convention seem relevant: Article 6

(right to a fair trial) Article 14 (prohibition of discrimination) and Article 1 of the First Protocol (protection of property).

### **Community Safety**

2.13 In relation to section 17 of the Crime and Disorder Act 1998, this states:

‘Without prejudice to any other obligation imposed on it, it shall be the duty of each authority to which this section applies to exercise its various functions with due regard to the likely effect of the exercise of those functions on, and the need to do all that it reasonably can to prevent, crime and disorder in its area.’

The Borough Commander has not made a representation against this application.

### **Financial Implications**

2.14 There are no financial implications.

### **Risk Management Implications**

2.15 If any party is aggrieved with the decision of the licensing panel on one of the grounds set out in Schedule 5 to the Licensing Act 2003, they can appeal to a Magistrates’ Court. The Appeal period is 21 days from notification of the decision.

## **Section 3 - Statutory Officer Clearance**

|                                     |                                     |                                             |
|-------------------------------------|-------------------------------------|---------------------------------------------|
| Name: Kanta Hirani                  | <input checked="" type="checkbox"/> | on behalf of the<br>Chief Financial Officer |
| Date: 16 <sup>th</sup> January 2012 |                                     |                                             |
| Name: Paresh Mehta                  | <input checked="" type="checkbox"/> | on behalf of the<br>Monitoring Officer      |
| Date: 25 <sup>th</sup> January 2012 |                                     |                                             |

## **Section 4 - Contact Details and Background Papers**

**Contact:** P Sivashankar, Licensing Services Manager x 6237

**Background Papers:** Application, Plan of the premises, Representations, Location (GIS) Map

**Application for a premises licence to be granted  
under the Licensing Act 2003**

**PLEASE READ THE FOLLOWING INSTRUCTIONS FIRST**

Before completing this form please read the guidance notes at the end of the form.  
If you are completing this form by hand please write legibly in block capitals. In all cases ensure that your answers are inside the boxes and written in black ink. Use additional sheets if necessary.

You may wish to keep a copy of the completed form for your records.

I/We Mylvaganam Asokan

*(Insert name(s) of applicant)*

apply for a premises licence under section 17 of the Licensing Act 2003 for the premises described in Part 1 below (the premises) and I/we are making this application to you as the relevant licensing authority in accordance with section 12 of the Licensing Act 2003

**Part 1 – Premises Details**

|                                                                                      |        |           |         |
|--------------------------------------------------------------------------------------|--------|-----------|---------|
| Postal address of premises or, if none, ordnance survey map reference or description |        |           |         |
| Hill Foods                                                                           |        |           |         |
| 43 High Street                                                                       |        |           |         |
| Harrow on the Hill                                                                   |        |           |         |
| Post town                                                                            | Harrow | Post code | HA1 3HT |

|                                         |        |
|-----------------------------------------|--------|
| Telephone number at premises (if any)   |        |
| Non-domestic rateable value of premises | £17250 |

**Part 2 - Applicant Details**

Please state whether you are applying for a premises licence as

Please tick yes

- a) an individual or individuals \*  please complete section (A)
- b) a person other than an individual \*
- i. as a limited company  please complete section (B)
- ii. as a partnership  please complete section (B)
- iii. as an unincorporated association or  please complete section (B)
- iv. other (for example a statutory corporation)  please complete section (B)
- c) a recognised club  please complete section (B)
- d) a charity  please complete section (B)

- e) the proprietor of an educational establishment  please complete section (B)
- f) a health service body  please complete section (B)
- g) a person who is registered under Part 2 of the Care Standards Act 2000 (c14) in respect of an independent hospital  please complete section (B)
- h) the chief officer of police of a police force in England and Wales  please complete section (B)

\* If you are applying as a person described in (a) or (b) please confirm:

Please tick yes

- I am carrying on or proposing to carry on a business which involves the use of the premises for licensable activities; or
- I am making the application pursuant to a
  - statutory function or
  - a function discharged by virtue of Her Majesty's prerogative

**(A) INDIVIDUAL APPLICANTS (fill in as applicable)**

|                                        |                              |                               |                             |                                                     |  |
|----------------------------------------|------------------------------|-------------------------------|-----------------------------|-----------------------------------------------------|--|
| <input checked="" type="checkbox"/> Mr | <input type="checkbox"/> Mrs | <input type="checkbox"/> Miss | <input type="checkbox"/> Ms | Other Title (for example, Rev)                      |  |
| Surname<br>Asokan                      |                              |                               | First names<br>Mylvaganam   |                                                     |  |
| I am 18 years old or over              |                              |                               |                             | <input checked="" type="checkbox"/> Please tick yes |  |
| [REDACTED ADDRESS]                     |                              |                               |                             |                                                     |  |
| Daytime contact telephone number       |                              |                               |                             |                                                     |  |
| E-mail address (optional)              |                              |                               |                             |                                                     |  |

**SECOND INDIVIDUAL APPLICANT (if applicable)**

|                             |                              |                               |                             |                                          |  |
|-----------------------------|------------------------------|-------------------------------|-----------------------------|------------------------------------------|--|
| <input type="checkbox"/> Mr | <input type="checkbox"/> Mrs | <input type="checkbox"/> Miss | <input type="checkbox"/> Ms | Other Title (for example, Rev)           |  |
| Surname                     |                              |                               | First names                 |                                          |  |
| I am 18 years old or over   |                              |                               |                             | <input type="checkbox"/> Please tick yes |  |

|                                                           |  |          |  |
|-----------------------------------------------------------|--|----------|--|
| Current postal address if different from premises address |  |          |  |
| Post Town                                                 |  | Postcode |  |
| Daytime contact telephone number                          |  |          |  |
| E-mail address (optional)                                 |  |          |  |

**(B) OTHER APPLICANTS**

Please provide name and registered address of applicant in full. Where appropriate please give any registered number. In the case of a partnership or other joint venture (other than a body corporate), please give the name and address of each party concerned.

|                                                                                               |
|-----------------------------------------------------------------------------------------------|
| Name                                                                                          |
| Address                                                                                       |
| Registered number (where applicable)                                                          |
| Description of applicant (for example, partnership, company, unincorporated association etc.) |
| Telephone number (if any)                                                                     |
| E-mail address (optional)                                                                     |

**Part 3 Operating Schedule**

When do you want the premises licence to start?

|                  |       |      |
|------------------|-------|------|
| Day              | Month | Year |
| 1-9-0-1-2 0 1-2- |       |      |

If you wish the licence to be valid only for a limited period, when do you want it to end?

|     |       |      |
|-----|-------|------|
| Day | Month | Year |
|     |       |      |

Please give a general description of the premises (please read guidance note1)  
A Grocery shop that is to be known as Hill Foods. The applicant wishes to supply alcohol off the premises for the following days and timings:  
Monday - Saturdays 07:00 – 23:00 hours and Sundays and Bank Holidays 09:00 - 22:00 hours.

The applicant is willing to provide measures to support 4 licensing objectives (see Part P of the operating schedule). These measures are offered subject to the grant of a premises licence.

If 5,000 or more people are expected to attend the premises at any one time, please state the number expected to attend.

What licensable activities do you intend to carry on from the premises?

(Please see sections 1 and 14 of the Licensing Act 2003 and Schedules 1 and 2 to the Licensing Act 2003)

**Provision of regulated entertainment**

Please tick yes

- a) plays (if ticking yes, fill in box A)
- b) films (if ticking yes, fill in box B)
- c) indoor sporting events (if ticking yes, fill in box C)
- d) boxing or wrestling entertainment (if ticking yes, fill in box D)
- e) live music (if ticking yes, fill in box E)
- f) recorded music (if ticking yes, fill in box F)
- g) performances of dance (if ticking yes, fill in box G)
- h) anything of a similar description to that falling within (e), (f) or (g) (if ticking yes, fill in box H)

**Provision of entertainment facilities:**

- i) making music (if ticking yes, fill in box I)
- j) dancing (if ticking yes, fill in box J)
- k) entertainment of a similar description to that falling within (i) or (j) (if ticking yes, fill in box K)

**Provision of late night refreshment** (if ticking yes, fill in box L)

**Supply of alcohol** (if ticking yes, fill in box M)

In all cases complete boxes N, O and P

**M**

|                                                                                     |       |        |                                                                                                                                                                                                     |                  |                                     |
|-------------------------------------------------------------------------------------|-------|--------|-----------------------------------------------------------------------------------------------------------------------------------------------------------------------------------------------------|------------------|-------------------------------------|
| <b>Supply of alcohol</b><br>Standard days and timings (please read guidance note 6) |       |        | <b>Will the supply of alcohol be for consumption (Please tick box)</b> (please read guidance note 7)                                                                                                | On the premises  | <input type="checkbox"/>            |
|                                                                                     |       |        |                                                                                                                                                                                                     | Off the premises | <input checked="" type="checkbox"/> |
| Day                                                                                 | Start | Finish | Both                                                                                                                                                                                                |                  |                                     |
| Mon                                                                                 | 07:00 | 23:00  | <b>State any seasonal variations for the supply of alcohol</b> (please read guidance note 4)                                                                                                        |                  |                                     |
| Tue                                                                                 | 07:00 | 23:00  |                                                                                                                                                                                                     |                  |                                     |
| Wed                                                                                 | 07:00 | 23:00  |                                                                                                                                                                                                     |                  |                                     |
| Thur                                                                                | 07:00 | 23:00  | <b>Non standard timings. Where you intend to use the premises for the supply of alcohol at different times to those listed in the column on the left, please list</b> (please read guidance note 5) |                  |                                     |
| Fri                                                                                 | 07:00 | 23:00  |                                                                                                                                                                                                     |                  |                                     |
| Sat                                                                                 | 07:00 | 23:00  |                                                                                                                                                                                                     |                  |                                     |
| Sun                                                                                 | 09:00 | 22:00  |                                                                                                                                                                                                     |                  |                                     |

State the name and details of the individual whom you wish to specify on the licence as premises supervisor

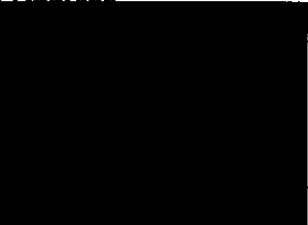
|                                                                                                       |
|-------------------------------------------------------------------------------------------------------|
| <b>Name</b><br>Mylvaganam Asokan                                                                      |
| <b>Address</b><br> |
| <b>Personal Licence number (if known)</b><br>To be applied for                                        |
| <b>Issuing licensing authority (if known)</b><br>Harrow Council                                       |

**N**

**Please highlight any adult entertainment or services, activities, other entertainment or matters ancillary to the use of the premises that may give rise to concern in respect of children (please read guidance note 8)**

Not applicable

**O**

| <b>Hours premises are open to the public</b><br>Standard days and timings (please read guidance note 6) |       |        | <b>State any seasonal variations</b> (please read guidance note 4)                                                                                                                            |
|---------------------------------------------------------------------------------------------------------|-------|--------|-----------------------------------------------------------------------------------------------------------------------------------------------------------------------------------------------|
| Day                                                                                                     | Start | Finish |                                                                                                                                                                                               |
| Mon                                                                                                     | 07:00 | 23:00  | <b>Non standard timings. Where you intend the premises to be open to the public at different times from those listed in the column on the left, please list</b> (please read guidance note 5) |
| Tue                                                                                                     | 07:00 | 23:00  |                                                                                                                                                                                               |
| Wed                                                                                                     | 07:00 | 23:00  |                                                                                                                                                                                               |
| Thur                                                                                                    | 07:00 | 23:00  |                                                                                                                                                                                               |
| Fri                                                                                                     | 07:00 | 23:00  |                                                                                                                                                                                               |
| Sat                                                                                                     | 07:00 | 23:00  |                                                                                                                                                                                               |
| Sun                                                                                                     | 09:00 | 22:00  |                                                                                                                                                                                               |



**P** Describe the steps you intend to take to promote the four licensing objectives:

**a) General – all four licensing objectives (b,c,d,e) (please read guidance note 9)**

\*CCTV for prevention and detection of crime  
\*Statutory fire fighting equipment  
\*Suitable receptacles to dispose of commercial & customer rubbish/litter  
\*Staff training in age restricted sales policy  
(All conditions offered in this operating schedule will be installed/maintained subject to a premises licence being granted.)

**b) The prevention of crime and disorder**

CCTV system will be installed and in operation at the premises.  
CCTV signage will be displayed.  
The till will be secured to the counter.

**c) Public safety**

Fire fighting equipment (fire extinguishers will be installed and maintained at the premises.  
Fire Exit/s will be signed and kept clear of all obstructions.

**d) The prevention of public nuisance**

Signage will be prominently displayed requesting customers to respect local residents (i) not to litter in the vicinity, (ii) to leave the premises in a quiet and orderly fashion.  
The applicant is to keep the immediate area outside the premises clear from litter.

**e) The protection of children from harm**

All staff are to be trained in an Age Verification policy to prevent under age sales of alcohol.  
A refusal register will be maintained.

Please tick yes

- I have made or enclosed payment of the fee
- I have enclosed the plan of the premises
- I have sent copies of this application and the plan to responsible authorities and others where applicable
- I have enclosed the consent form completed by the individual I wish to be premises supervisor, if applicable
- I understand that I must now advertise my application
- I understand that if I do not comply with the above requirements my application will be rejected

**IT IS AN OFFENCE, LIABLE ON CONVICTION TO A FINE UP TO LEVEL 5 ON THE STANDARD SCALE, UNDER SECTION 158 OF THE LICENSING ACT 2003 TO MAKE A FALSE STATEMENT IN OR IN CONNECTION WITH THIS APPLICATION**

**Part 4 – Signatures** (please read guidance note 10)

**Signature of applicant or applicant’s solicitor or other duly authorised agent** (See guidance note 11). If signing on behalf of the applicant please state in what capacity.

|           |                                                                                   |
|-----------|-----------------------------------------------------------------------------------|
| Signature |  |
| Date      | 21 <sup>st</sup> December 2011                                                    |
| Capacity  | Licensing Agent - Authorised                                                      |

**For joint applications signature of 2<sup>nd</sup> applicant or 2<sup>nd</sup> applicant’s solicitor or other authorised agent.** (please read guidance note 12). If signing on behalf of the applicant please state in what capacity.

|           |                                                                                      |
|-----------|--------------------------------------------------------------------------------------|
| Signature |  |
| Date      |                                                                                      |
| Capacity  |                                                                                      |

|                                                                                                                                                        |             |           |         |
|--------------------------------------------------------------------------------------------------------------------------------------------------------|-------------|-----------|---------|
| <b>Contact name (where not previously given) and postal address for correspondence associated with this application</b> (please read guidance note 13) |             |           |         |
| Accu price services ltd<br>Imperial Place<br>Unit 4<br>Maxwell Road                                                                                    |             |           |         |
| Post town                                                                                                                                              | Borehamwood | Post code | WD6 1JN |
|                                                                    |             |           | onal)   |

**Consent of individual to being specified as premises supervisor**

**Mylvaganam Asokan**

I .....  
*[full name of prospective premises supervisor]*

of



.....  
*[home address of prospective premises supervisor]*

hereby confirm that I give my consent to be specified as the designated premises supervisor in relation to the application for application for a premises licence

.....  
*[type of application]*

by

**Mylvaganam Asokan**

.....  
*[name of applicant]*

relating to a premises licence **None** .....  
*[number of existing licence, if any]*

for

Hill Foods  
43 High Street  
Harrow on the Hill  
HA1 3HT

.....  
*[name and address of premises to which the application relates]*

and any premises licence to be granted or varied in respect of this application made by

Mylvaganam Asokaran

*[name of applicant]*

concerning the supply of alcohol at

Hill Foods

43 High Street

Harrow on the Hill

HA1 3HT

*[name and address of premises to which application relates]*

I also confirm that I am applying for, intend to apply for or currently hold a personal licence, details of which I set out below.

Personal licence number

To be applied for

*[insert personal licence number, if any]*

Personal licence issuing authority

Harrow Council, Civic Centre, Station Road, Harrow, Middlesex, HA1 2UT, 0208 863 5611.

*[insert name and address and telephone number of personal licence issuing authority, if any]*

Signed



Name (please print)

Mylvaganam Asokan

Date

16 December 2011

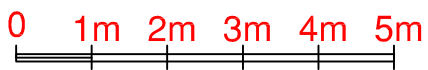
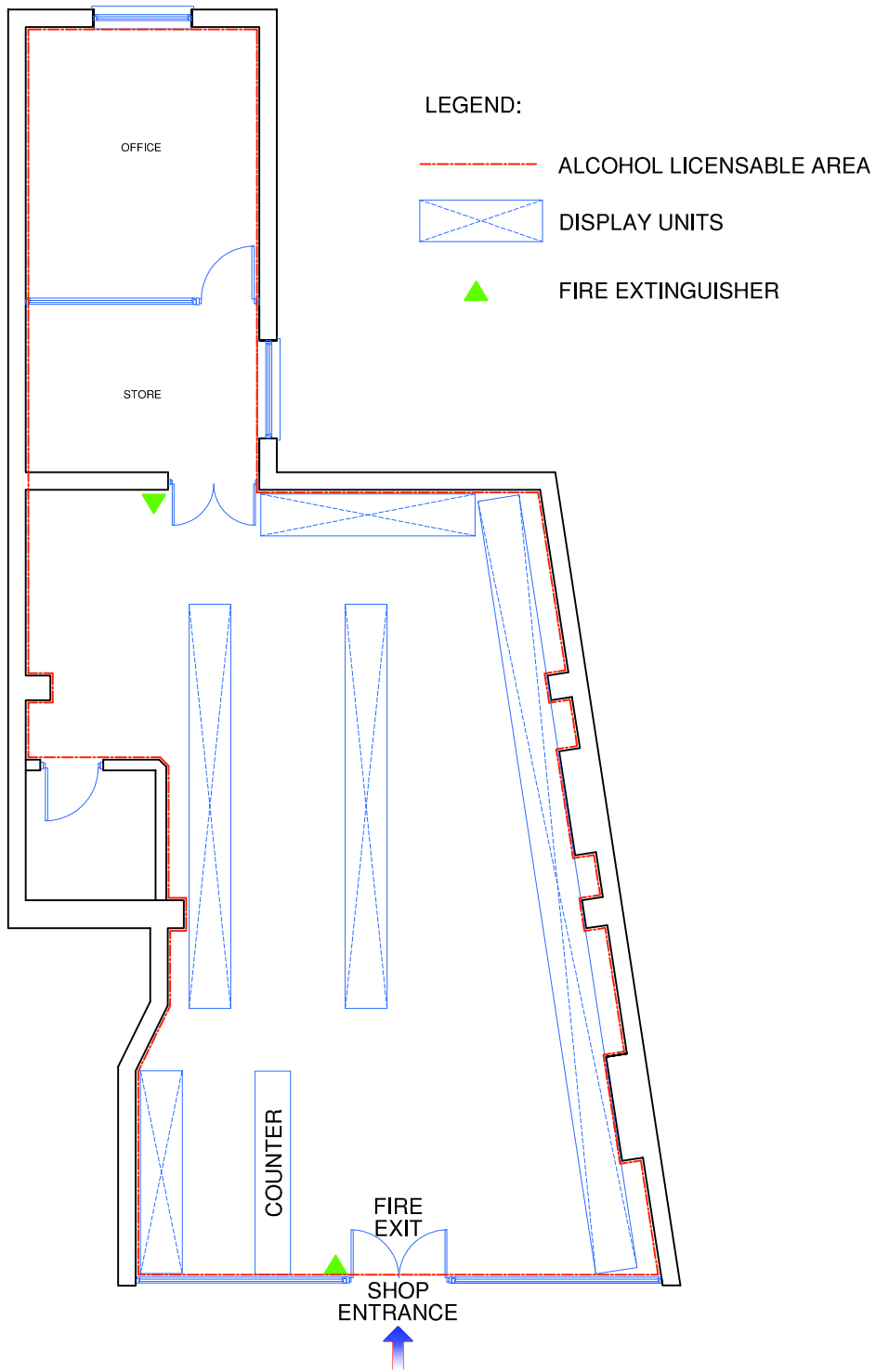

|                                                                                                                                                                                          |                                                                  |  |
|------------------------------------------------------------------------------------------------------------------------------------------------------------------------------------------|------------------------------------------------------------------|--|
|                                                                                                      | <b>STUDIO CAD PROJECTS</b><br>Architectural & Interior Designers |  |
|                                                                                                                                                                                          | TEL: 079 581 581 90<br>E-mail: scprojects@onet.eu                |  |
| PROJECT:<br>Shop Oakwoods, 43 High Street,<br>Harrow-on-the-Hill, Harrow, HA1 3HZ<br>EXISTING SHOP LAYOUT                                                                                |                                                                  |  |
| SCALE: 1:100 (A4)<br>DATE: NOV 2011                                                                                                                                                      | PROJECT No:<br>2111105-1                                         |  |
| THIS DRAWING MUST NOT BE REPRODUCED, MULTIPLIED<br>OR SUBMITTED TO THE INSPECTION OF THIRD PARTIES<br>WITHOUT OUR PRIOR PERMISSION.<br>ALL DIMENSIONS TO BE CHECKED AND VERIFIED ON SITE |                                                                  |  |

This page is intentionally left blank

Hill Foods, 43 High Street, Harrow on the Hill, HA1 3HZ



This page is intentionally left blank



Dr. S. D. Flatres



20th January 2012

Dear Sir / Madam,

I am writing to give my support to a licence application for 43 High Street, Harrow-on-the-Hill. As a local resident, I am often frustrated by the lack of an ability to buy alcohol on the Hill and frequently make the journey to South Harrow for such purposes. However, this is often an inconvenience and I wholeheartedly welcome the possibility of this changing.

With regards to the potential of local youths having increased access to alcohol, I do not believe this to be an issue. The simple reason is that the shops here already sell an 18 rated product, namely nicotine with no issues. The applicant is familiar with the local population and I have no doubt that they would be diligent in checking identification.

Yours faithfully,

Dr. S. D. Flatres



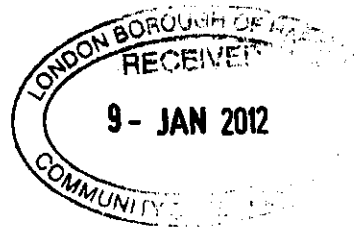

6 January 2012

Chief Environmental Health Officer  
London Borough of Harrow  
Civic Centre  
PO Box 18  
Harrow HA1 2UT

Dear Sir

**Premises License Application – 43 High Street, Harrow on the Hill**

I am in receipt of a letter from Mr Ash Waghela, Licensing Support Officer, dated 30 December 2011 (ref; ce/css/lic/HFR1) concerning the above.

With regard to the application for a liquor license for the above premises I wish to make the following points:

- I do not have any objection at all to the principle of the application in terms of liquor being sold from those premises as it will be a further amenity for Harrow on the Hill.
- I do, however, wish to raise an objection to the hours during which liquor will be able to be sold. I note that every day, liquor could be sold until 11pm which I feel is too late for the following reasons;
  - The shop's current operating hours are different from that time and it usually closes much earlier than 11pm
  - Is the shop owner proposing to have longer operating hours now?
  - If liquor is sold until 11pm each day I feel there will be a risk of an increased level of public nuisance at that late hour.

In summary, whilst I support the application, I do have concerns about the 11pm time in the proposal and therefore request that this time should be earlier to link in with the opening hours of the shop

I will be very happy to expand on the above points if it is considered necessary.

Yours faithfully



Douglas Benham

Cc Ash Waghela

1

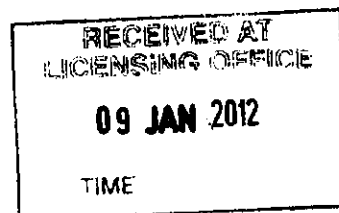

This page is intentionally left blank



**H A R R O W**  
**S C H O O L**

19 January 2012

Harrow Council  
Community Safety Services  
Civic Centre  
PO Box 18  
Station Road  
Harrow  
Middlesex HA1 2UT

**For the attention of Mr Ash Waghela**

Dear Sirs,

**LICENSING ACT 2003 – NEW PREMISES LICENCE APPLICATION FOR HILL FOODS,  
43 HIGH STREET, HARROW ON THE HILL, MIDDLESEX HA1 3HT - OBJECTION**

Thank you for your letter dated 30 December 2011 notifying us of an application for the sale of alcohol for the above premises.

Harrow School object to the granting of this licence on the following grounds:

The Protection of Children from Harm

This shop, formally known as Oakwoods, is visited on a daily basis by numerous children from local schools including Harrow School. Whilst we acknowledge that the applicant has stated that "All staff will be trained in an Age Verification policy to prevent underage sales of alcohol" in reality this can be extremely difficult to monitor and enforce.

In addition to the close proximity of other Schools and Sixth Form Colleges, these premises are located at the heart of Harrow School with 820 pupils who also live at the School seven days per week throughout term time. It is for this reason that such a high proportion of children visit these premises and a licence to sell alcohol would put them at risk.

Cont'd...

**The Estates Bursar, T.J. Gray FRICS**



The Prevention of Public Nuisance, Crime and Disorder

Having regard to the extended hours proposed and the small green immediately opposite, it is felt that the sale of alcohol could easily result in the creation of a public nuisance and the possibility of crime and disorder, particularly during the extended daylight hours of spring and summer months.

This is a predominantly residential area and alcohol abuse could put local residents including pupils at Harrow School at risk in each of those respects.

Previous applications for a licence to sell alcohol from these premises have been refused and it is hoped that this application will also be refused.

Yours faithfully,

A large black rectangular redaction box covering the signature area.

TREVOR GRAY

## REPORT FOR: LICENSING PANEL

|                             |                                                                                                              |
|-----------------------------|--------------------------------------------------------------------------------------------------------------|
| <b>Date:</b>                | 6 March 2012                                                                                                 |
| <b>Subject:</b>             | Application to vary a premises licence in respect of 'Kemps Fish Bar', 327, High Road, Harrow Weald. HA3 5EQ |
| <b>Responsible Officer:</b> | Brendon Hills – Corporate Director, Community & Environment                                                  |
| <b>Exempt:</b>              | No                                                                                                           |
| <b>Enclosures:</b>          | Application to vary a premises licence<br>Representations<br>Current Premises Licence<br>Location (GIS) Map  |

### Section 1 – Summary

The application to a vary a premises licence issued under the Licensing Act 2003 to Kemps Fish Bar, 327 High Road, Harrow Weald has attracted representations from interested parties. As per the Council's Licensing Policy and delegation of Licensing functions, all applications with unresolved representations are to be dealt by the Licensing Panel.

### Representations received

| From                                                                     | Relevant Representations details |
|--------------------------------------------------------------------------|----------------------------------|
| The Planning Authority                                                   | No representations received      |
| Health & Safety                                                          | No representations received      |
| Environmental Health Authority (Pollution and environmental enforcement) | No representations received      |
| Trading Standards                                                        | No representations received      |
| The Area Child Protection Service                                        | No representations received      |
| LFEPA                                                                    | No representations received      |
| Metropolitan Police                                                      | No representations received      |

### Representations from interested parties

| From               | Relevant Representations details |
|--------------------|----------------------------------|
| Interested Parties | Representations Received         |

## Section 2 – Report

### Current situation

2.1 An application has been made to vary a premises licence in respect of “Kemps Fish Bar”, 327 High Road, Harrow Weald (‘the Premises’).

2.2 The Premises currently has the benefit of a Premises Licence which was granted in 2005 under the Transitional arrangements. Briefly the current premises licence authorises the following licensable activities and timings:

Sale of alcohol (for consumption on the premises only):

Mondays to Sundays 11.00am – 11.00pm

Late Night Refreshment:

Sundays to Thursdays 11.00pm – Midnight

Fridays and Saturdays 11.00pm – 01.00am (next day)

Hours Open to Public:

Sundays to Thursdays 11.00pm – Midnight

Fridays and Saturdays 11.00pm – 01.00am (next day)

2.3 Initially the variation application sought to extend the timings for licensable activities until 02.00am the following morning on each night and the addition of recorded music. However following discussions with the Police Licensing Sergeant, the applicant has amended his application.

2.4 The application now seeks to extend the timings for licensable activities as follows and to include the provision of Recorded Music as another licensable activity:

Sale of Alcohol (for consumption on or off the premises):

Sundays to Thursdays 11.00am - Midnight

Fridays and Saturdays 11.00am – 01.00am (next day)

Recorded Music:

Sunday to Thursday 11.00am - midnight

Friday and Saturday 11.00am - 01.00am (next day)

2.5 The applicant’s proposed steps to promote the licensing objectives are listed in Section P of the application.

### Representations

2.6 The application to vary a premises licence has attracted six representations from interested parties. These representations primarily raise issues pertaining to the prevention of public nuisance which the panel should consider when determining the application. The panel cannot consider issues that do not go towards the promotion of the licensing objectives and can only consider matters pertaining to the licensing objectives raised in the representations and any supporting documentation submitted in accordance with the Licensing Act 2003 (Hearings) Regulations 2005.



- 2.7 Copies of all the representations received are attached to this report.

## **Consultation**

- 2.8 The application was advertised in accordance with the Regulations under the Licensing Act 2003.

## **Licensing Policy Implications**

- 2.9 In relation to the Council's Licensing policy at paragraphs 8.3 and 8.8, the applicant has addressed how he intends to promote the licensing objectives.

## **Legal Implications**

- 2.10 The Licensing Panel is required to hold a hearing to consider the variation application and any relevant representations unless all parties agree that a hearing is unnecessary. The hearing must be held in accordance with the Licensing Act 2003 (Hearings) Regulations 2005.
- 2.11 The Licensing Panel is required to give appropriate weight to the representations (including supporting information) presented by all the parties, the Guidance issued pursuant to section 182 of the Licensing Act 2003, the Council's statement of licensing policy and the steps that are necessary to promote the four licensing objectives.
- 2.12 Having considered those relevant matters, the Licensing Panel is required to take such of following steps (if any) as it considers necessary for the promotion of the four licensing objectives –

- a. To modify the conditions of the licence
- b. To reject the whole or part of the application

and for this purpose the conditions of the licence are modified if any of them is altered or omitted or any new conditions added.

- 2.13 It should be noted with all options that –
- Clear reasons should be given for the decision.
  - Any additional or modified conditions should be practical and enforceable
  - The applicant and any person who made relevant representations would have the right of appeal to a magistrates' court on one of the grounds provided in Schedule 5 to the Licensing Act 2003
- 2.14 In addition to determining the application in accordance with the legislation, Members must have regard to –
- The common law rules of natural justice
  - The provisions of the Human Rights Act 1998
  - The considerations in section 17 of the Crime and Disorder Act 1998

- 2.15 By section 6 of the Human Rights Act 1998, the Panel is required to act in a way that is compatible with rights under the European Convention for the Protection of Human Rights. The following provisions of the European convention seem relevant: Article 6 (right to a fair trial) Article 14 (prohibition of discrimination) and Article 1 of the First Protocol (protection of property).

### **Community Safety**

- 2.16 In relation to section 17 of the Crime and Disorder Act 1998, this states:

‘Without prejudice to any other obligation imposed on it, it shall be the duty of each authority to which this section applies to exercise its various functions with due regard to the likely effect of the exercise of those functions on, and the need to do all that it reasonably can to prevent, crime and disorder in its area.’

The Borough Commander has not made a representation against this application.

### **Financial Implications**

- 2.17 There are no financial implications.

### **Risk Management Implications**

- 2.18 If any party is aggrieved with the decision of the licensing panel on one of the grounds set out in Schedule 5 to the Licensing Act 2003, they can appeal to a Magistrates’ Court. The Appeal period is 21 days from notification of the decision.

## **Section 3 - Statutory Officer Clearance**

|                    |                          |                                              |
|--------------------|--------------------------|----------------------------------------------|
| Name: Kanta Hirani | <input type="checkbox"/> | on behalf of the*<br>Chief Financial Officer |
| Date:              |                          |                                              |
| Name: Paresh Mehta | <input type="checkbox"/> | on behalf of the*<br>Monitoring Officer      |
| Date:              |                          |                                              |

## **Section 4 - Contact Details and Background Papers**

**Contact:** P Sivashankar, Licensing Services Manager x 6237

**Background Papers:** Current Licence, Licensing Act 2003, Statutory Guidance

[Insert name and address of relevant licensing authority and its reference number (optional)]

### Application to vary a premises licence under the Licensing Act 2003

#### PLEASE READ THE FOLLOWING INSTRUCTIONS FIRST

Before completing this form please read the guidance notes at the end of the form.  
If you are completing this form by hand please write legibly in block capitals. In all cases ensure that your answers are inside the boxes and written in black ink. Use additional sheets if necessary.  
You may wish to keep a copy of the completed form for your records.

I/We BALWINDER SINGH CHHOKAR  
(Insert name(s) of applicant) being the premises licence holder, apply to vary a premises licence under section 34 of the Licensing Act 2003 for the premises described in Part 1 below

Premises licence number

LN000000948/2010/3

#### Part 1 – Premises details

|                                                                                                                                                         |                             |
|---------------------------------------------------------------------------------------------------------------------------------------------------------|-----------------------------|
| Postal address of premises or, if none, Ordnance Survey map reference, or description<br><u>KEMPS FISH BAR</u><br><u>327 HIGH ROAD</u><br><u>HARLOW</u> |                             |
| Post town<br><u>HARLOW</u>                                                                                                                              | Post code<br><u>HA3 5EP</u> |

Telephone number at premises (if any)

[Redacted]

Non-domestic rateable value of premises

£8,600

#### Part 2 – Applicant details

Daytime contact telephone number

[Redacted]

E-mail address (optional)

[Redacted]

Current postal address if different from premises address

[Redacted]

Post Town

[Redacted]

Postcode

[Redacted]



**Part 3 - Variation**

Do you want the proposed variation to have effect as soon as possible?

Please tick Yes

If not do you want the variation to take effect from

| Day | Month | Year |
|-----|-------|------|
|     |       |      |

If your proposed variation would mean that 5,000 or more people are expected to attend the premises at any one time, please state the number expected to attend

**Please describe briefly the nature of the proposed variation (Please see guidance note 1)**

TO EXTEND THE HOURS FOR  
RECORDED MUSIC, LATE NIGHT REFRESHMENT  
AND SALE OF ALCOHOL FROM 11 PM TO  
THE PUBLIC AS PER THE APPLICATION

## Part 4 Operating Schedule

Please complete those parts of the Operating Schedule below which would be subject to change if this application to vary is successful.

Please tick ✓ yes

### Provision of regulated entertainment

- a) plays (if ticking yes, fill in box A)
- b) films (if ticking yes, fill in box B)
- c) indoor sporting events (if ticking yes, fill in box C)
- d) boxing or wrestling entertainment (if ticking yes, fill in box D)
- e) live music (if ticking yes, fill in box E)
- f) recorded music (if ticking yes, fill in box F)
- g) performances of dance (if ticking yes, fill in box G)
- h) anything of a similar description to that falling within (e), (f) or (g)  
(if ticking yes, fill in box H)

### Provision of entertainment facilities for:

- i) making music (if ticking yes, fill in box I)
- j) dancing (if ticking yes, fill in box J)
- k) entertainment of a similar description to that falling within (i) or (j)  
(if ticking yes, fill in box K)

### Provision of late night refreshment (if ticking yes, fill in box L)

### Sale by retail of alcohol (if ticking yes, fill in box M)

In all cases complete boxes N, O and P

**A**

| Plays<br>Standard days and timings (please read guidance note 6) |       |        | Will the performance of a play take place indoors or outdoors or both – please tick [Y] (please read guidance note 2) | Indoors                                                                                                                                                                                         |  |  |
|------------------------------------------------------------------|-------|--------|-----------------------------------------------------------------------------------------------------------------------|-------------------------------------------------------------------------------------------------------------------------------------------------------------------------------------------------|--|--|
| Day                                                              | Start | Finish |                                                                                                                       | Outdoors                                                                                                                                                                                        |  |  |
| Mon                                                              |       |        | Please give further details here (please read guidance note 3)                                                        |                                                                                                                                                                                                 |  |  |
| Tue                                                              |       |        |                                                                                                                       |                                                                                                                                                                                                 |  |  |
| Wed                                                              |       |        |                                                                                                                       | State any seasonal variations for performing plays (please read guidance note 4)                                                                                                                |  |  |
| Thur                                                             |       |        |                                                                                                                       |                                                                                                                                                                                                 |  |  |
| Fri                                                              |       |        |                                                                                                                       | Non standard timings. Where you intend to use the premises for the performance of plays at different times to those listed in the column on the left, please list (please read guidance note 5) |  |  |
| Sat                                                              |       |        |                                                                                                                       |                                                                                                                                                                                                 |  |  |
| Sun                                                              |       |        |                                                                                                                       |                                                                                                                                                                                                 |  |  |

**B**

| Films<br>Standard days and timings (please read guidance note 6) |       |        | Will the exhibition of films take place indoors or outdoors or both – please tick [Y] (please read guidance note 2) | Indoors                                                                                                                                                                                        |  |  |
|------------------------------------------------------------------|-------|--------|---------------------------------------------------------------------------------------------------------------------|------------------------------------------------------------------------------------------------------------------------------------------------------------------------------------------------|--|--|
| Day                                                              | Start | Finish |                                                                                                                     | Outdoors                                                                                                                                                                                       |  |  |
| Mon                                                              |       |        | Please give further details here (please read guidance note 3)                                                      |                                                                                                                                                                                                |  |  |
| Tue                                                              |       |        |                                                                                                                     |                                                                                                                                                                                                |  |  |
| Wed                                                              |       |        |                                                                                                                     | State any seasonal variations for the exhibition of films (please read guidance note 4)                                                                                                        |  |  |
| Thur                                                             |       |        |                                                                                                                     |                                                                                                                                                                                                |  |  |
| Fri                                                              |       |        |                                                                                                                     | Non standard timings. Where you intend to use the premises for the exhibition of films at different times to those listed in the column on the left, please list (please read guidance note 5) |  |  |
| Sat                                                              |       |        |                                                                                                                     |                                                                                                                                                                                                |  |  |
| Sun                                                              |       |        |                                                                                                                     |                                                                                                                                                                                                |  |  |

**C**

|                                                                                          |       |        |                                                                                                                                                                                               |
|------------------------------------------------------------------------------------------|-------|--------|-----------------------------------------------------------------------------------------------------------------------------------------------------------------------------------------------|
| <b>Indoor sporting events</b><br>Standard days and timings (please read guidance note 6) |       |        | Please give further details (please read guidance note 3)                                                                                                                                     |
| Day                                                                                      | Start | Finish |                                                                                                                                                                                               |
| Mon                                                                                      |       |        | State any seasonal variations for indoor sporting events (please read guidance note 4)                                                                                                        |
| Tue                                                                                      |       |        |                                                                                                                                                                                               |
| Wed                                                                                      |       |        |                                                                                                                                                                                               |
| Thur                                                                                     |       |        | Non standard timings. Where you intend to use the premises for indoor sporting events at different times to those listed in the column on the left, please list (please read guidance note 5) |
| Fri                                                                                      |       |        |                                                                                                                                                                                               |
| Sat                                                                                      |       |        |                                                                                                                                                                                               |
| Sun                                                                                      |       |        |                                                                                                                                                                                               |

**D**

|                                                                                                      |       |        |                                                                                                                                                                                                          |          |  |
|------------------------------------------------------------------------------------------------------|-------|--------|----------------------------------------------------------------------------------------------------------------------------------------------------------------------------------------------------------|----------|--|
| <b>Boxing or wrestling entertainments</b><br>Standard days and timings (please read guidance note 6) |       |        | Will the boxing or wrestling entertainment take place indoors or outdoors or both – please tick [Y] (please read guidance note 2)                                                                        | Indoors  |  |
| Day                                                                                                  | Start | Finish |                                                                                                                                                                                                          | Outdoors |  |
| Mon                                                                                                  |       |        | Please give further details here (please read guidance note 3)                                                                                                                                           | Both     |  |
| Tue                                                                                                  |       |        |                                                                                                                                                                                                          |          |  |
| Wed                                                                                                  |       |        |                                                                                                                                                                                                          |          |  |
| Thur                                                                                                 |       |        | State any seasonal variations for boxing or wrestling entertainment (please read guidance note 4)                                                                                                        |          |  |
| Fri                                                                                                  |       |        |                                                                                                                                                                                                          |          |  |
| Sat                                                                                                  |       |        |                                                                                                                                                                                                          |          |  |
|                                                                                                      |       |        | Non standard timings. Where you intend to use the premises for boxing or wrestling entertainment at different times to those listed in the column on the left, please list (please read guidance note 5) |          |  |
|                                                                                                      |       |        |                                                                                                                                                                                                          |          |  |

|     |  |  |  |
|-----|--|--|--|
| Sun |  |  |  |
|-----|--|--|--|

**E**

| Live music<br>Standard days and timings (please read guidance note 6) |       |        | Will the performance of live music take place indoors or outdoors or both – please tick [Y] (please read guidance note 2) | Indoors                                                                                                                                                                                              |  |
|-----------------------------------------------------------------------|-------|--------|---------------------------------------------------------------------------------------------------------------------------|------------------------------------------------------------------------------------------------------------------------------------------------------------------------------------------------------|--|
| Day                                                                   | Start | Finish |                                                                                                                           | Outdoors                                                                                                                                                                                             |  |
| Mon                                                                   |       |        | Please give further details here (please read guidance note 3)                                                            | Both                                                                                                                                                                                                 |  |
| Tue                                                                   |       |        |                                                                                                                           |                                                                                                                                                                                                      |  |
| Wed                                                                   |       |        |                                                                                                                           | State any seasonal variations for the performance of live music (please read guidance note 4)                                                                                                        |  |
| Thur                                                                  |       |        |                                                                                                                           |                                                                                                                                                                                                      |  |
| Fri                                                                   |       |        |                                                                                                                           | Non standard timings. Where you intend to use the premises for the performance of live music at different times to those listed in the column on the left, please list (please read guidance note 5) |  |
| Sat                                                                   |       |        |                                                                                                                           |                                                                                                                                                                                                      |  |
| Sun                                                                   |       |        |                                                                                                                           |                                                                                                                                                                                                      |  |

**F**

| Recorded music<br>Standard days and timings (please read guidance note 6) |                        |        | Will the playing of recorded music take place indoors or outdoors or both – please tick [Y] (please read guidance note 2) | Indoors                                                                                | <input checked="" type="checkbox"/> |
|---------------------------------------------------------------------------|------------------------|--------|---------------------------------------------------------------------------------------------------------------------------|----------------------------------------------------------------------------------------|-------------------------------------|
| Day                                                                       | Start                  | Finish |                                                                                                                           | Outdoors                                                                               |                                     |
| Mon                                                                       | 0000 0200<br>1100 0000 |        | Please give further details here (please read guidance note 3)                                                            | Both                                                                                   |                                     |
| Tue                                                                       | 0000 0200<br>1100 0000 |        |                                                                                                                           |                                                                                        |                                     |
| Wed                                                                       | 0000 0200<br>1100 0000 |        |                                                                                                                           | State any seasonal variations for playing recorded music (please read guidance note 4) |                                     |
| Thur                                                                      | 0000 0200<br>1100 0000 |        |                                                                                                                           |                                                                                        |                                     |



|     |      |      |                                                                                                                                                                                                                    |
|-----|------|------|--------------------------------------------------------------------------------------------------------------------------------------------------------------------------------------------------------------------|
| Fri | 0000 | 0200 | Non standard timings. Where you intend to use the premises for the playing of recorded music entertainment at different times to those listed in the column on the left, please list (please read guidance note 5) |
|     | 1100 | 0000 |                                                                                                                                                                                                                    |
| Sat | 0000 | 0200 |                                                                                                                                                                                                                    |
|     | 1100 | 0000 |                                                                                                                                                                                                                    |
| Sun | 0000 | 0200 |                                                                                                                                                                                                                    |
|     | 1100 | 0000 |                                                                                                                                                                                                                    |

**G**

|                                                                                         |       |        |                                                                                                                                                                                                               |          |  |
|-----------------------------------------------------------------------------------------|-------|--------|---------------------------------------------------------------------------------------------------------------------------------------------------------------------------------------------------------------|----------|--|
| <b>Performances of dance</b><br>Standard days and timings (please read guidance note 6) |       |        | Will the performance of dance take place indoors or outdoors or both – please tick [Y] (please read guidance note 2)                                                                                          | Indoors  |  |
|                                                                                         |       |        |                                                                                                                                                                                                               | Outdoors |  |
| Day                                                                                     | Start | Finish |                                                                                                                                                                                                               |          |  |
| Mon                                                                                     |       |        | Please give further details here (please read guidance note 3)                                                                                                                                                |          |  |
| Tue                                                                                     |       |        |                                                                                                                                                                                                               |          |  |
| Wed                                                                                     |       |        | State any seasonal variations for the performance of dance (please read guidance note 4)                                                                                                                      |          |  |
| Thur                                                                                    |       |        |                                                                                                                                                                                                               |          |  |
| Fri                                                                                     |       |        | Non standard timings. Where you intend to use the premises for the performance of dance entertainment at different times to those listed in the column on the left, please list (please read guidance note 5) |          |  |
| Sat                                                                                     |       |        |                                                                                                                                                                                                               |          |  |
| Sun                                                                                     |       |        |                                                                                                                                                                                                               |          |  |

**H**

|                                                                                                                                            |       |        |                                                                                                                |         |  |
|--------------------------------------------------------------------------------------------------------------------------------------------|-------|--------|----------------------------------------------------------------------------------------------------------------|---------|--|
| <b>Anything of a similar description to that falling within (e), (f) or (g)</b><br>Standard days and timings (please read guidance note 6) |       |        | Please give a description of the type of entertainment you will be providing                                   |         |  |
| Day                                                                                                                                        | Start | Finish | Will this entertainment take place indoors or outdoors or both – please tick [Y] (please read guidance note 2) | Indoor  |  |
|                                                                                                                                            |       |        |                                                                                                                | Outdoor |  |
| Mon                                                                                                                                        |       |        | Both                                                                                                           |         |  |

|      |  |  |                                                                                                                                                                                                                                                               |
|------|--|--|---------------------------------------------------------------------------------------------------------------------------------------------------------------------------------------------------------------------------------------------------------------|
| Tue  |  |  | <b>Please give further details here</b> (please read guidance note 3)                                                                                                                                                                                         |
| Wed  |  |  |                                                                                                                                                                                                                                                               |
| Thur |  |  |                                                                                                                                                                                                                                                               |
| Fri  |  |  | <b>State any seasonal variations for entertainment of a similar description to that falling within (e), (f) or (g)</b> (please read guidance note 4)                                                                                                          |
| Sat  |  |  | <b>Non standard timings. Where you intend to use the premises for the entertainment of similar description to that falling within (e), (f) or (g) at different times to those listed in the column on the left, please list</b> (please read guidance note 5) |
| Sun  |  |  |                                                                                                                                                                                                                                                               |

|                                                                                                            |       |        |                                                                                                                                                                                                                                      |  |  |
|------------------------------------------------------------------------------------------------------------|-------|--------|--------------------------------------------------------------------------------------------------------------------------------------------------------------------------------------------------------------------------------------|--|--|
| <b>Provision of facilities for making music</b><br>Standard days and timings (please read guidance note 6) |       |        | <b>Please give a description of the facilities for making music you will be providing</b>                                                                                                                                            |  |  |
|                                                                                                            |       |        | Will the facilities for making music be indoors or outdoors or both – please tick [Y] (please read guidance note 2)                                                                                                                  |  |  |
|                                                                                                            |       |        | Indoors                                                                                                                                                                                                                              |  |  |
|                                                                                                            |       |        | Outdoors                                                                                                                                                                                                                             |  |  |
|                                                                                                            |       |        | Both                                                                                                                                                                                                                                 |  |  |
| Day                                                                                                        | Start | Finish |                                                                                                                                                                                                                                      |  |  |
| Mon                                                                                                        |       |        | <b>Please give further details here</b> (please read guidance note 3)                                                                                                                                                                |  |  |
| Tue                                                                                                        |       |        |                                                                                                                                                                                                                                      |  |  |
| Wed                                                                                                        |       |        | <b>State any seasonal variations for the provision of facilities for making music</b> (please read guidance note 4)                                                                                                                  |  |  |
| Thur                                                                                                       |       |        |                                                                                                                                                                                                                                      |  |  |
| Fri                                                                                                        |       |        | <b>Non standard timings. Where you intend to use the premises for provision of facilities for making music entertainment at different times to those listed in the column on the left, please list</b> (please read guidance note 5) |  |  |
| Sat                                                                                                        |       |        |                                                                                                                                                                                                                                      |  |  |
| Sun                                                                                                        |       |        |                                                                                                                                                                                                                                      |  |  |

| Provision of facilities for dancing<br>Standard days and timings (please read guidance note 6) |       |        | Will the facilities for dancing be indoors or outdoors or both – please tick [Y] (see guidance note 2)                                                                                                                       | Indoors  |  |
|------------------------------------------------------------------------------------------------|-------|--------|------------------------------------------------------------------------------------------------------------------------------------------------------------------------------------------------------------------------------|----------|--|
|                                                                                                |       |        |                                                                                                                                                                                                                              | Outdoors |  |
|                                                                                                |       |        |                                                                                                                                                                                                                              | Both     |  |
| Day                                                                                            | Start | Finish | Please give a description of the facilities for dancing you will be providing                                                                                                                                                |          |  |
| Mon                                                                                            |       |        | Please give further details here (please read guidance note 3)                                                                                                                                                               |          |  |
| Tue                                                                                            |       |        |                                                                                                                                                                                                                              |          |  |
| Wed                                                                                            |       |        | State any seasonal variations for providing dancing facilities (please read guidance note 4)                                                                                                                                 |          |  |
| Thur                                                                                           |       |        |                                                                                                                                                                                                                              |          |  |
| Fri                                                                                            |       |        | Non standard timings. Where you intend to use the premises for the provision of facilities for dancing entertainment at different times to those listed in the column on the left, please list (please read guidance note 5) |          |  |
| Sat                                                                                            |       |        |                                                                                                                                                                                                                              |          |  |
| Sun                                                                                            |       |        |                                                                                                                                                                                                                              |          |  |

**K**

| Provision of facilities for entertainment of a similar description to that falling within I or J<br>Standard days and timings (please read guidance note 6) |       |        | Please give a description of the type of entertainment facility you will be providing                          |         |  |
|-------------------------------------------------------------------------------------------------------------------------------------------------------------|-------|--------|----------------------------------------------------------------------------------------------------------------|---------|--|
| Day                                                                                                                                                         | Start | Finish | Will the entertainment facility be indoors or outdoors or both – please tick [Y] (please read guidance note 2) | Indoor  |  |
|                                                                                                                                                             |       |        |                                                                                                                | Outdoor |  |
| Mon                                                                                                                                                         |       |        |                                                                                                                | Both    |  |

|      |  |  |                                                                                                                                                                                                                                                                             |
|------|--|--|-----------------------------------------------------------------------------------------------------------------------------------------------------------------------------------------------------------------------------------------------------------------------------|
| Tue  |  |  | Please give further details here (please read guidance note 3)                                                                                                                                                                                                              |
| Wed  |  |  |                                                                                                                                                                                                                                                                             |
| Thur |  |  |                                                                                                                                                                                                                                                                             |
| Fri  |  |  | State any seasonal variations for the provision of facilities for entertainment of a similar description to that falling within I or J (please read guidance note 4)                                                                                                        |
| Sat  |  |  | Non standard timings. Where you intend to use the premises for the provision of facilities for entertainment of a similar description to that falling within I or J at different times to those listed in the column on the left, please list (please read guidance note 5) |
| Sun  |  |  |                                                                                                                                                                                                                                                                             |

| Late night refreshment<br>Standard days and timings (please read guidance note 6) |              |              | Will the provision of late night refreshment take place indoors or outdoors or both – please tick [Y] (please read guidance note 2)                                                                             | Indoors  | <input checked="" type="checkbox"/> |
|-----------------------------------------------------------------------------------|--------------|--------------|-----------------------------------------------------------------------------------------------------------------------------------------------------------------------------------------------------------------|----------|-------------------------------------|
| Day                                                                               | Start        | Finish       |                                                                                                                                                                                                                 | Outdoors | <input type="checkbox"/>            |
| Mon                                                                               | 0000<br>2300 | 0200<br>0000 | Please give further details here (please read guidance note 3)                                                                                                                                                  | Both     | <input type="checkbox"/>            |
| Tue                                                                               | 0000<br>2300 | 0200<br>0000 |                                                                                                                                                                                                                 |          |                                     |
| Wed                                                                               | 0000<br>2300 | 0200<br>0000 | State any seasonal variations for the provision of late night refreshment (please read guidance note 4)                                                                                                         |          |                                     |
| Thur                                                                              | 0000<br>2300 | 0200<br>0000 |                                                                                                                                                                                                                 |          |                                     |
| Fri                                                                               | 0000<br>2300 | 0200<br>0000 | Non standard timings. Where you intend to use the premises for the provision of late night refreshment at different times, to those listed in the column on the left, please list (please read guidance note 5) |          |                                     |
| Sat                                                                               | 0000<br>2300 | 0200<br>0000 |                                                                                                                                                                                                                 |          |                                     |
| Sun                                                                               | 0000<br>2300 | 0200<br>0000 |                                                                                                                                                                                                                 |          |                                     |

**M**

|                                                                                     |              |              |                                                                                               |                  |                                     |                                                                                                                                                                                                     |  |  |
|-------------------------------------------------------------------------------------|--------------|--------------|-----------------------------------------------------------------------------------------------|------------------|-------------------------------------|-----------------------------------------------------------------------------------------------------------------------------------------------------------------------------------------------------|--|--|
| <b>Supply of alcohol</b><br>Standard days and timings (please read guidance note 6) |              |              | Will the sale of alcohol be for consumption (Please tick box Y) (please read guidance note 7) | On the premises  | <input checked="" type="checkbox"/> |                                                                                                                                                                                                     |  |  |
|                                                                                     |              |              |                                                                                               | Off the premises | <input checked="" type="checkbox"/> |                                                                                                                                                                                                     |  |  |
| Day                                                                                 | Start        | Finish       | Both <input type="checkbox"/>                                                                 |                  |                                     |                                                                                                                                                                                                     |  |  |
| Mon                                                                                 | 0000<br>1100 | 0200<br>0600 | State any seasonal variations for the supply of alcohol (please read guidance note 4)         |                  |                                     |                                                                                                                                                                                                     |  |  |
| Tue                                                                                 | 0000<br>1100 | 0200<br>0000 |                                                                                               |                  |                                     |                                                                                                                                                                                                     |  |  |
| Wed                                                                                 | 0000<br>1100 | 0200<br>0000 |                                                                                               |                  |                                     |                                                                                                                                                                                                     |  |  |
| Thur                                                                                | 0000<br>1100 | 0200<br>0000 |                                                                                               |                  |                                     | <b>Non-standard timings. Where you intend to use the premises for the supply of alcohol at different times to those listed in the column on the left, please list (please read guidance note 5)</b> |  |  |
| Fri                                                                                 | 0000<br>1100 | 0200<br>0000 |                                                                                               |                  |                                     |                                                                                                                                                                                                     |  |  |
| Sat                                                                                 | 0000<br>1100 | 0200<br>0000 |                                                                                               |                  |                                     |                                                                                                                                                                                                     |  |  |
| Sun                                                                                 | 0000<br>1100 | 0200<br>0000 |                                                                                               |                  |                                     |                                                                                                                                                                                                     |  |  |
|                                                                                     |              |              |                                                                                               |                  |                                     |                                                                                                                                                                                                     |  |  |

**N**

Please highlight any adult entertainment or services, activities, other entertainment or matters ancillary to the use of the premises that may give rise to concern in respect of children (please read guidance note 8)

NONE

**O**

|                                                                                                         |              |              |                                                             |  |  |
|---------------------------------------------------------------------------------------------------------|--------------|--------------|-------------------------------------------------------------|--|--|
| <b>Hours premises are open to the public</b><br>Standard days and timings (please read guidance note 6) |              |              | State any seasonal variations (please read guidance note 4) |  |  |
| Day                                                                                                     | Start        | Finish       |                                                             |  |  |
| Mon                                                                                                     | 0000<br>1100 | 0200<br>0000 |                                                             |  |  |
| Tue                                                                                                     | 0000<br>1100 | 0200<br>0000 |                                                             |  |  |

|      |      |      |                                                                                                                                                                                                      |
|------|------|------|------------------------------------------------------------------------------------------------------------------------------------------------------------------------------------------------------|
| Wed  | 0000 | 0200 | <b>Non standard timings. Where you intend to use the premises to be open to the public at different times from those listed in the column on the left, please list (please read guidance note 5)</b> |
|      | 1100 | 0000 |                                                                                                                                                                                                      |
| Thur | 0000 | 0200 |                                                                                                                                                                                                      |
|      | 1100 | 0000 |                                                                                                                                                                                                      |
| Fri  | 0000 | 0200 |                                                                                                                                                                                                      |
|      | 1100 | 0000 |                                                                                                                                                                                                      |
| Sat  | 0000 | 0200 |                                                                                                                                                                                                      |
|      | 1100 | 0000 |                                                                                                                                                                                                      |
| Sun  | 0000 | 0200 |                                                                                                                                                                                                      |
|      | 1100 | 0000 |                                                                                                                                                                                                      |

Please identify those conditions currently imposed on the licence which you believe could be removed as a consequence of the proposed variation you are seeking

- I have enclosed the premises licence  **yes**
- I have enclosed the relevant part of the premises licence
- If you have not ticked one of these boxes please fill in reasons for not including the licence, or part of it, below

Reasons why I have failed to enclose the premises licence or relevant part of premises licence

**P**

Describe any additional steps you intend to take to promote the four licensing objectives as a result of the proposed variation:

a) General – all four licensing objectives (b,c,d,e) (please read guidance note 9)

b) The prevention of crime and disorder

CCTV IN OPERATION AS PER  
CURRENT LICENCE

c) Public safety

CCTV IN OPERATION AS PER  
CURRENT LICENCE.

d) The prevention of public nuisance

NOTICE AT EXIT ASKING ALL CUSTOMERS  
TO LEAVE QUIETLY AND TO RESPECT THE  
LOCAL RESIDENTS.  
LITTER TO BE CLEANED UP OUTSIDE THE  
PREMISES.

e) The protection of children from harm

PROOF OF AGE OVER 21 SCHEME

Please tick ✓ yes

- I have made or enclosed payment of the fee
- I have sent copies of this application and the plan to responsible authorities and others where applicable
- I understand that I must now advertise my application
- I have enclosed the premises licence or relevant part of it or explanation
- I understand that if I do not comply with the above requirements my application will be rejected

**IT IS AN OFFENCE, LIABLE ON CONVICTION TO A FINE UP TO LEVEL 5 ON THE STANDARD SCALE, UNDER SECTION 158 OF THE LICENSING ACT 2003 TO MAKE A FALSE STATEMENT IN OR IN CONNECTION WITH THIS APPLICATION**

**Part 5 – Signatures** (please read guidance note 10)

Signature of applicant (the current premises licence holder) or applicant's solicitor or other duly authorised agent (please read guidance note 11). If signing on behalf of the applicant please state in what capacity.

Signature   
Date 10/11/12  
Capacity OWNER / LICENSEE

Where the premises licence is jointly held signature of 2<sup>nd</sup> applicant (the current premises licence holder) or 2<sup>nd</sup> applicant's solicitor or other authorised agent (please read guidance note 12). If signing on behalf of the applicant please state in what capacity.

Signature  
Date  
Capacity

|                                                                                                                                          |                                                                                     |
|------------------------------------------------------------------------------------------------------------------------------------------|-------------------------------------------------------------------------------------|
| Contact name (where not previously given) and address for correspondence associated with this application (please read guidance note 13) |                                                                                     |
| Post town                                                                                                                                | Post code                                                                           |
| Telephone number (if any)                                                                                                                |  |
| If you would prefer us to correspond with you by e-mail your e-mail address (optional)                                                   |                                                                                     |



**From:** BS CHHOKAR <[REDACTED]>  
**To:** "licensing@harrow.gov.uk" <licensing@harrow.gov.uk>  
**Date:** 24/01/2012 16:54  
**Subject:** Fw: Alcohol licence (extending)

----- Forwarded Message -----

**From:** BS CHHOKAR <[REDACTED]>  
**To:** "licensing@harrow.gov" <licensing@harrow.gov>  
**Cc:** "john.crump@met.police.uk" <john.crump@met.police.uk>  
**Sent:** Tuesday, 24 January 2012, 16:38  
**Subject:** Alcohol licence (extending)

My name is Balwinder Singh Chhokar, my premises license number is LN/000000948/2010/3 at the address, Kemps Fish Bar, 327 High Road Harrow HA3 5EQ.

I applied to extend the Licencable activity's as per the application to reduce hours after consulting with the police, Licencable activitys and hours open to public the following,

Closing Times

MON-THU: 11:00 - 00:00

FRI - SAT: 11:00 - 1:00

Please change this in my application, I would like to request this grant.  
If any problems please call me on my mobile 07958935719

Thank you very much.

BS Chhokar

This page is intentionally left blank

**From:** Phillip O'Dell [REDACTED]  
**To:** Phil O'Dell [REDACTED]  
**Date:** 29/01/2012 20:48  
**Subject:** FW:

---

Message Received: Jan 29 2012, 03:21 PM  
From: "Amarat Patel"  
To: "wealdstonecouncillors@harrowlabour.org"  
Cc:  
Subject: (no subject)

Sent from my iPad

Dear councillor Rekha

We have been living at Weald lane for thirty three years, and seen all the changes out of all of these, this one is most outrageous.

How can any one even consider about giving licence to stay open till 2am plus allow to sell alcohol. It's like asking for trouble, few years ago I felt quite safe walking on top of Weald lane in the evening, not now.

We totally oppose granting this kind of licence to Kemps Fish Bar, I hope we have made quite clear about this issue.

Yours faithfully,  
Amart Patel,

[REDACTED]

[REDACTED]

This page is intentionally left blank

**From:** licensing  
**To:** Angela Sanders  
**Date:** 27/01/2012 11:34  
**Subject:** RE: Licensing Act 2003 - Variation - Kemps Fish Bar HA8 7DD

Dear all,

This premises is a restaurant and takeaway. The current licence only permits sale of retail alcohol for consumption on the premises only. The variation application is for the sale of retail alcohol for consumption on and off the premises.

The Authority will treat your email as a representation and forward this to the applicant.

Regards  
Ash Waghela  
Licensing Support Officer.

>>> Angela Sanders <[REDACTED]> 27/01/2012 11:18 >>>

Dear All,

With reference to the below – we are not happy with this and would voice our original objections again – the shop being open is not the problem as such, it's the sale of alcohol until these hours that concerns us. There is already a pub 3 doors down in both directions which provides supervised alcohol consumption, is the alcohol confined to the restaurant section (which on our observations is not used) or is it going to be takeaway?

Kind regards,

Angela & Jonathan Sanders

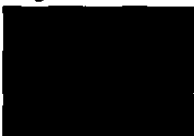

**From:** licensing [mailto:licensing@harrow.gov.uk]  
**Sent:** 27 January 2012 11:05  
**To:** Angela Sanders; Margaret Davine; Mrinal Choudhury; Nana Asante; wealdstonecouncillors@harrowlabour.org  
**Subject:** Licensing Act 2003 - Variation - Kemps Fish Bar HA8 7DD

Dear All,

With reference to the above, and after consultation with the police, the applicant has instructed the authority that he will reduce the hours for all licensable activities and hours open to the public to:

Monday - Thursday - 11 - 00:00  
Friday - Saturday - 11:00 - 01:00

Sunday - 11:00 - 00:00

The effect this will have on the licence is that he is bringing the sale of retail alcohol hours in line with his opening hours that are currently on the licence.

I hope this information is useful to you. If you would still like to make a representation in respect of the application, the authority must receive this by 7 February 2012.

Regards  
Ash Waghela  
Licensing Support Officer.

**From:** Phillip O'Dell [REDACTED]  
**To:** <phillip.odell@harrow.gov.uk>  
**Date:** 27/01/2012 09:48  
**Subject:** FW: Premises licence variation: Kemps Fish Bar, High Road, HarrowWeald

---

Message Received: Jan 27 2012, 09:38 AM  
From: "Angela Sanders"  
To: "'wealdstonecouncillors@harrowlabour.org'"  
Cc:  
Subject: Premises licence variation: Kemps Fish Bar, High Road, Harrow Weald

Dear Councillors,

We do understand that in these hard times all businesses must try to diversify, but as a resident of Weald Lane we will have to object to the extension of this licence variation, especially the alcohol. Our road is used as a cut through for late night revellers coming off the night buses and from Harrow town centre. There have been a number of incidents where we have been woken from 12pm through till the early hours of the morning, and on occasion have had to either move people on or call the police due to disturbances. During the summer months this escalates as the daylight hours are longer so the crowds tend to gather at the top of the road. Having a license extended and to include alcohol (in a kebab shop!) till 2 a.m. would only fuel this issue.

We trust you will take these comments into consideration when making your final decision. Please keep us informed.

Kind regards,

Angela & Jonathan Sanders  
[REDACTED]

Ms Bernie Hennah  
[REDACTED]

**From:** Phillip O'Dell [REDACTED]  
**To:** Phil O'Dell <phillip.odell@harrow.gov.uk>  
**Date:** 31/01/2012 09:12  
**Subject:** FW: kemps Fish Bar

=====  
Message Received: Jan 30 2012, 06:06 PM  
From: "Bernie Hennah"  
To: "wealdstonecouncillors@harrowlabour.org"  
Cc:  
Subject: kemps Fish Bar

Dear Councillors

I am horrified to hear that Kemp's Fish Bar is applying to extend their opening hours to 2am each day. Weald Lane is plagued by the litter and mess generated by the many take away outlets and bars situated at the end of the road. Each day I clear half eaten kebabs, empty wrappers and cans from my driveway and the front of my house. The High Street is a disgrace each Saturday and Sunday morning and I feel embarrassed that my local area is so messy.

There are three pubs, one at the end of Weald lane and two on the High Street, when they close, Kemp's would be a venue for the customers to continue drinking until the early hours. The prospect of revellers leaving Kemp's at 2.00 am worries me, this is a residential area with families living above the venue and opposite.

At the end of Weald Lane there is a small green and a bench where down and outs sit drinking alcohol, it is also a place where youths congregate; as you can see we have more than enough problems here without adding to them by introducing a late night cafe.

My family has lived here for over 25 years and seen many changes, unfortunately not for the better, please protect our Lane from further noise and pollution.

Yours sincerely

Mrs Bernie Hennah  
[REDACTED]

Sent from my iPad

Phillip O'Dell

This page is intentionally left blank



**From:** Phillip O'Dell [REDACTED]  
**To:** Phil O'Dell <p[REDACTED]>  
**Date:** 29/01/2012 20:49  
**Subject:** FW: Premises licence variation: Kemps Fish Bar

=====  
Message Received: Jan 27 2012, 01:24 PM

**From:** [REDACTED]  
**To:** wealdstonecouncillors@harrowlabour.org  
**Cc:**  
**Subject:** Premises licence variation: Kemps Fish Bar

Dear Councillors,

Re: above:

Objections to application for Premises licence variation to Kemps Fish Bar:

1. extended open hours will lead to more social activity to 2 am and beyond.
2. social activity will need to be monitored by police and or community support officers.
3. if no active monitoring by these bodies social unrest may increase above the current level for the area.
4. there are within the immediate area three (4) licenced (alcohol) premises; two in weald lane, one near to Kemps Fish Bar and the Wealdstone Pub.
5. potential increased social activity in weald lane, including depositing of rubbish in our garden and on the pavement, rowdiness of passers bye.

As a resident in Weald Lane we object to this application, for the reasons above, and in particular the extended business hours to 2am with ability to purchase alcohol at this time.

Martin and Sandra Gilmore  
[REDACTED]

Phillip O'Dell

This page is intentionally left blank

**From:** Phillip O'Dell [REDACTED]  
**To:** Phil O'Dell <[REDACTED]>  
**Date:** 02/02/2012 11:40  
**Subject:** FW: Re: Premises licence variation objection: Kemps Fish Bar, High Road, Harrow Weald

=====  
Message Received: Feb 02 2012, 09:32 AM  
From: "Nandeesh Mehta "  
To: "Phillip O'Dell "  
Cc:  
Subject: Re: Premises licence variation objection: Kemps Fish Bar, High Road, Harrow Weald

Dear Phillip,

Thanks for your prompt response.

My address is [REDACTED]

Kind regards,

Nandeesh

Sent using [REDACTED]

-----Original Message-----

From: Phillip O'Dell  
Date: Thu, 2 Feb 2012 09:15:24  
To:  
Subject: RE: Premises licence variation objection: Kemps Fish Bar, High Road, Harrow Weald

Dear Nandesh Please can give your address so that we can pass your comments onto Harrow Council's Licensing Department ? Many thanks Cllr. Phillip O'Dell Wealdstone Ward

=====  
Message Received: Feb 01 2012, 09:53 PM  
From: "Nandeesh Mehta" To: wealdstonecouncillors@harrowlabour.org Cc: Subject: Premises licence variation objection: Kemps Fish Bar, High Road, Harrow Weald Dear Councillors, I hope you are well. Thank you for your services. I would like to address my concern about the variation of this licence request by Kemps Fish Bar, High Road, Harrow Weald. As per the letter received from you, the licence will allow them to start selling alcohol and that too until 2am every day! I live on Weald Lane which is on the same road and it is hard for us to sleep at night on certain days due to the current bars on the same and adjoining road. The addition of this liquor licence until 2am in this shop will add to the nuisance on my road which is fully residential including a big doctors surgery! It will add to dirt on the street too. It may also increase the chance of attempted crime and violence under the influence of the alcohol. I strongly object the granting of this licence and I hope you understand my reasons behind this objection. I look forward to hearing your thoughts on this. Kind regards Nandeesh

Phillip O'Dell

This page is intentionally left blank

Dear Sir,

We object most strongly to  
Kemps Fish Bar application to extend  
their opening hours to 2.0 AM every  
day including to supply alcohol.

We have lived here for 54 years - and  
often are disturbed by noise after 11.30 pm.  
Two cans have been placed on top of my  
hedge last night! Yours faithfully,

Pamela D. Howell,

PAMELA TROWELL

PRINTED PAPER

Harrow Council,  
Licensing Section,  
PO Box 18,  
Station Rd.,  
Harrow

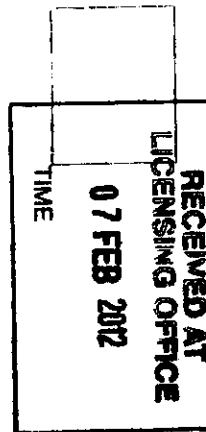

This page is intentionally left blank

# LICENSING ACT 2003

# Premises Licence

Schedule 12  
Part A (Regulation 33,34)  
HARROW COUNCIL, P O BOX 18, STATION ROAD, HARROW

Premises Licence Number: LN/000000948/2010/3

## Part 1 – Premises details

Postal address of premises, or if none, ordnance survey map reference or description:

**Kemps Fish Bar & Kebab Restaurant, 327 High Road, Harrow, Middlesex, HA3 5EQ**

Telephone Number:02084277178

Where the licence is time limited, the dates:

**N/A**

Licensable activities authorised by the licence:

Recorded music  
Late night refreshment  
Sale of retail alcohol

Signed by Finlay Flett  
Head of Community Safety Services



**Licensable area****Hours open to public**

|           |               |               |
|-----------|---------------|---------------|
| Sunday    | 00:00 - 01:00 | 11:00 - 00:00 |
| Monday    | 11:00 - 00:00 | -             |
| Tuesday   | 11:00 - 00:00 | -             |
| Wednesday | 11:00 - 00:00 | -             |
| Thursday  | 11:00 - 00:00 | -             |
| Friday    | 11:00 - 00:00 | -             |
| Saturday  | 00:00 - 01:00 | 11:00 - 00:00 |

1. ON CHRISTMAS DAY & GOOD FRIDAY: 12 NOON TO 11:30PM;
2. ON NEW YEAR'S EVE FROM THE END OF PERMITTED HOURS ON NEW YEAR'S EVE TO THE START OF PERMITTED HOURS ON THE FOLLOWING DAY (OR, IF THERE ARE NO PERMITTED HOURS ON THE FOLLOWING DAY, MIDNIGHT ON 31ST DECEMBER).

**The times the licence authorises the carrying out of licensable activities****Location: Licensable area****Recorded music - Unrestricted**

1. ON CHRISTMAS DAY & GOOD FRIDAY: 12 NOON TO 11:30PM;
2. ON NEW YEAR'S EVE FROM THE END OF PERMITTED HOURS ON NEW YEAR'S EVE TO THE START OF PERMITTED HOURS ON THE FOLLOWING DAY (OR, IF THERE ARE NO PERMITTED HOURS ON THE FOLLOWING DAY, MIDNIGHT ON 31ST DECEMBER).

**Location: Licensable area****Late night refreshment**

|           |               |               |
|-----------|---------------|---------------|
| Sunday    | 00:00 - 01:00 | 23:00 - 00:00 |
| Monday    | 23:00 - 00:00 | -             |
| Tuesday   | 23:00 - 00:00 | -             |
| Wednesday | 23:00 - 00:00 | -             |
| Thursday  | 23:00 - 00:00 | -             |
| Friday    | 23:00 - 00:00 | -             |
| Saturday  | 00:00 - 01:00 | 23:00 - 00:00 |

1. ON CHRISTMAS DAY & GOOD FRIDAY: 12 NOON TO 11:30PM;
2. ON NEW YEAR'S EVE FROM THE END OF PERMITTED HOURS ON NEW YEAR'S EVE TO THE START OF PERMITTED HOURS ON THE FOLLOWING DAY (OR, IF THERE ARE NO PERMITTED HOURS ON THE FOLLOWING DAY, MIDNIGHT ON 31ST DECEMBER).

**Location: Licensable area****Sale of retail alcohol**

|           |               |   |
|-----------|---------------|---|
| Sunday    | 11:00 - 23:00 | - |
| Monday    | 11:00 - 23:00 | - |
| Tuesday   | 11:00 - 23:00 | - |
| Wednesday | 11:00 - 23:00 | - |
| Thursday  | 11:00 - 23:00 | - |
| Friday    | 11:00 - 23:00 | - |
| Saturday  | 11:00 - 23:00 | - |

1. ON CHRISTMAS DAY & GOOD FRIDAY: 12 NOON TO 11:30PM;
2. ON NEW YEAR'S EVE FROM THE END OF PERMITTED HOURS ON NEW YEAR'S EVE TO THE START OF PERMITTED HOURS ON THE FOLLOWING DAY (OR, IF THERE ARE NO PERMITTED HOURS ON THE FOLLOWING DAY, MIDNIGHT ON 31ST DECEMBER).



Where the licence authorises supplies of alcohol – whether these are on and/or off supplies  
**Sale by retail on premises**



## Part 2

Name, (registered) address, telephone number and email (where relevant of holder of premises licence:

Balwinder Singh Chhokar



Rajinder Kaur Chhokar



Telephone [REDACTED]:

Registered number of holder, for example company number, charity number (where applicable):

Name, address and telephone number of designated premises supervisor where the premises licence authorises for the supply of alcohol:

Balwinder Singh Chhokar



Personal licence number and issuing authority of personal licence held by designated premises supervisor – where the premises licence authorises for the supply of alcohol:  
**DARLINGTON - DL05/00910/PERCON**

State whether access to the premises by children is restricted or prohibited: **N/A**

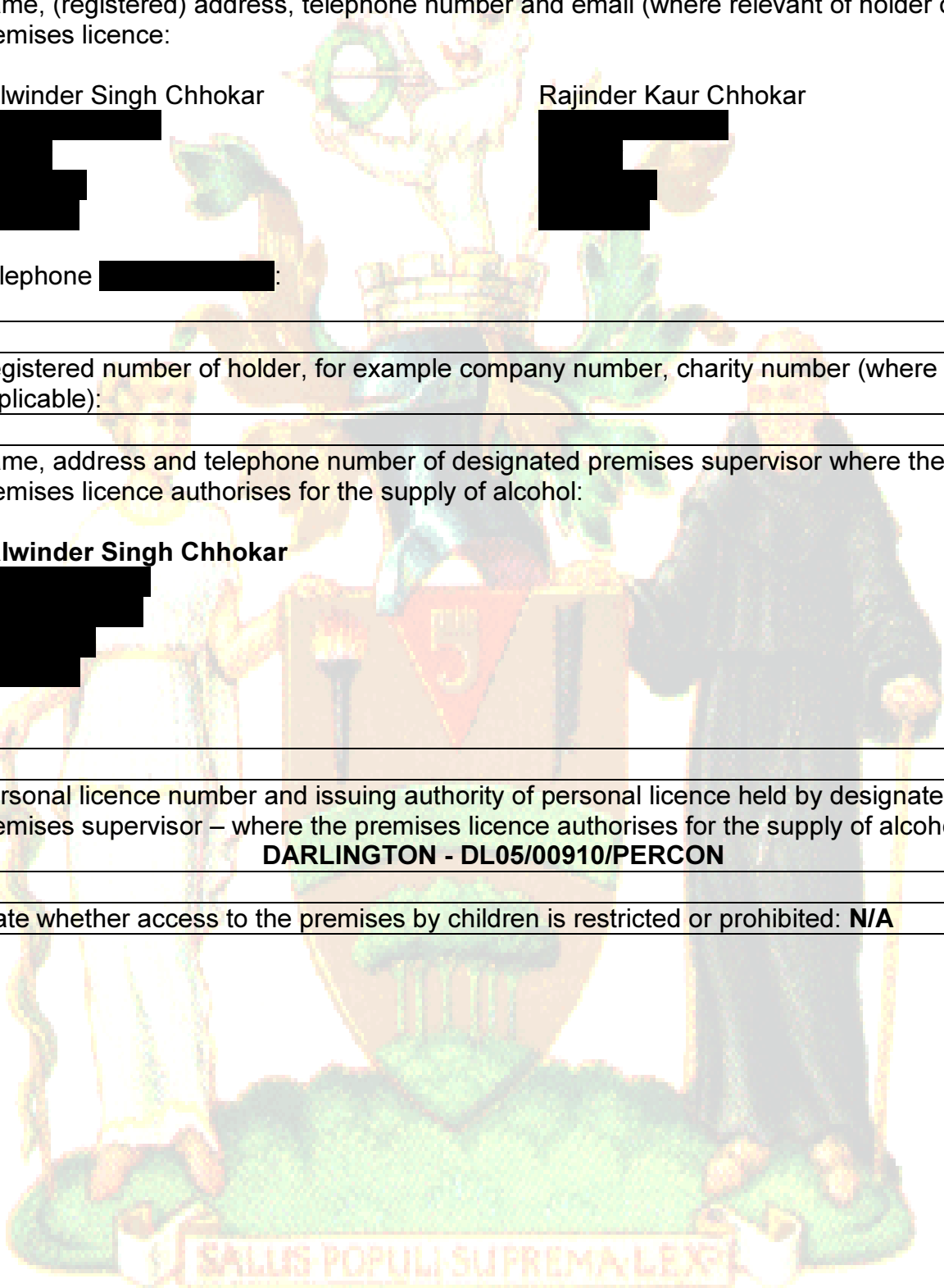

## Annex 1 – Mandatory Conditions

Mandatory conditions where licence authorises supply of alcohol:

- 1 No supply of alcohol may be made under the premises licence -
  - a) at a time when there is no designated premises supervisor in respect of the premises licence, or
  - b) at a time when the designated premises supervisor does not hold a personal licence or his personal licence is suspended
2. Every supply or sale of alcohol made under the premises licence must be made or authorised by a person who holds a personal licence.

Mandatory conditions where licence authorises exhibition of films:

- (1) The admission of persons under the age of 18 years to exhibitions of films must be restricted in accordance with any recommendation made by the British Board of Film Classification, except where condition 2 applies.
- (2) The admission of persons under the age of 18 years to exhibitions of films must be restricted in accordance with any recommendation made by the relevant licensing authority regarding the film in question

Mandatory condition where licence requires door supervision:

Where one or more individuals are required to be at the premises to carry out a security activity, such individual(s) must be licensed by the Security Industry Authority.

## Annex 2 - Conditions consistent with the operating Schedule

1. CCTV SYSTEM TO BE MAINTAINED AND OPERATED IN GOOD ORDER AND TO THE SATISFACTION OF METROPOLITAN POLICE CRIME PREVENTION OFFICER'S REASONABLE REQUEST.
2. A MONITORED CENTRAL STATION ALARM AND SECURITY SYSTEM TO BE MAINTAINED AND OPERATED IN GOOD ORDER AND TO THE SATISFACTION OF METROPOLITAN POLICE CRIME PREVENTION OFFICER'S REASONABLE REQUEST.

Annex 3 - Conditions attached after a hearing by the licensing authority.

NONE

Annex 4 – Plan  
Attached.

|                                    |                                    |
|------------------------------------|------------------------------------|
| Date of original grant: 21/12/2005 | Reason for issue: Variation Of DPS |
| Date of issue: 7th September 2010  | Issue Number: 3                    |

This page is intentionally left blank

**Kemps Fish Bar & Kebab Restaurant, 327 High Road, Harrow, Middlesex, HA3 5EQ**



This page is intentionally left blank